

带定位楔紧块

—标准型—

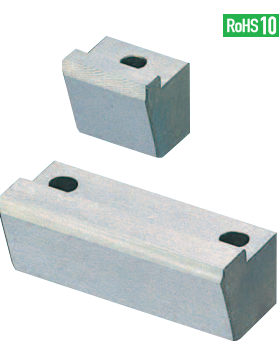

RoHS10

LBCSK

A=13~23时

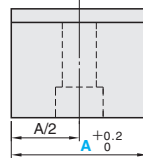

A=28~78时

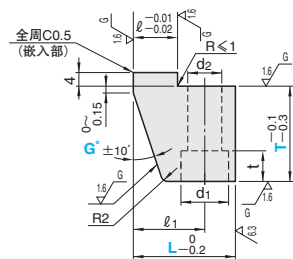
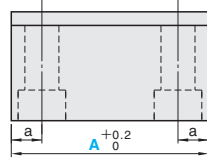

● 嵌入部の強度計算 P.1402

型号	材质	硬度
嵌入部4mm LBCSK	相当于SKS3	53~56HRC

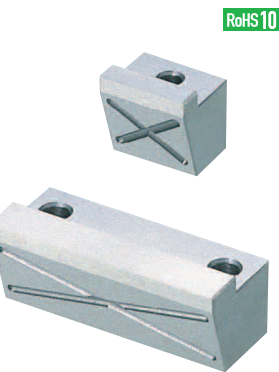

RoHS10

LBCSM (油槽型)

A=15~23时

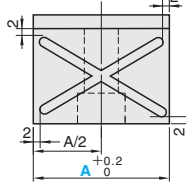

A=28~78时

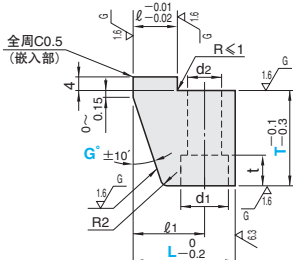
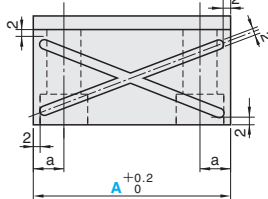

● 油槽部放大图

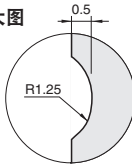

● 嵌入部の強度計算 P.1402

型号	材质	硬度
嵌入部4mm LBCSM	相当于SKS3	53~56HRC

a	l	l1	d1	d2	t	型号		A							G*							
						Type	L	T														
6	6	13	9.5	5.5	6	LBCSK	20	10	13	15	18	23	28	33	38	48	17	20	22			
								15	15	18	23	28	33	38	48	58	15	17	20	22		
								20	15	18	23	28	33	38	48	58	15	17				
								25	10	23	28	33	38	48	58	15	17	20	22			
								30	15	18	23	28	33	38	48	58	68	78	15	17	20	22
								35	15	18	23	28	33	38	48	58	68	78	15	17	20	22
7	10	17	11	6.5	7	LBCSK	25	10	15	18	23	28	33	38	48	58	68	78	15	17	20	22
								15	18	23	28	33	38	48	58	68	78	15	17	20	22	
								20	18	23	28	33	38	48	58	68	78	15	17	20	22	
								25	18	23	28	33	38	48	58	68	78	15	17	20	22	
								30	18	23	28	33	38	48	58	68	78	15	17	20	22	
								35	18	23	28	33	38	48	58	68	78	15	17	20	22	
8	13	21	14	9	9	LBCSK	30	25	33	38	48	58	68	78	15	17	20	22				
								30	33	38	48	58	68	78	15	17	20	22				
								35	33	38	48	58	68	78	15	17	20	22				
								40	33	38	48	58	68	78	15	17	20	22				
								45	33	38	48	58	68	78	15	17	20	22				
								50	33	38	48	58	68	78	15	17	20	22				
6	6	13	9.5	5.5	6	LBCSM (油槽型)	20	15	15	18	23	28	33	38	48	15	17	20	22			
								15	15	18	23	28	33	38	48	15	17	20	22			
								20	28	33	38	48	58	68	78	15	17	20	22			
								25	28	33	38	48	58	68	78	15	17	20	22			
								30	28	33	38	48	58	68	78	15	17	20	22			
								35	28	33	38	48	58	68	78	15	17	20	22			
7	10	17	11	6.5	7	LBCSM (油槽型)	25	15	28	33	38	48	58	68	78	15	17	20	22			
								20	28	33	38	48	58	68	78	15	17	20	22			
								25	28	33	38	48	58	68	78	15	17	20	22			
								30	28	33	38	48	58	68	78	15	17	20	22			
								35	28	33	38	48	58	68	78	15	17	20	22			
								40	28	33	38	48	58	68	78	15	17	20	22			
8	13	21	14	9	9	LBCSM (油槽型)	30	25	33	38	48	58	68	78	15	17	20	22				
								25	33	38	48	58	68	78	15	17	20	22				
								30	33	38	48	58	68	78	15	17	20	22				
								35	33	38	48	58	68	78	15	17	20	22				
								40	33	38	48	58	68	78	15	17	20	22				
								45	33	38	48	58	68	78	15	17	20	22				

Order 订货范例
 型号 — T — A — G
 LBCSK 30 — 25 — A58 — G15
 LBCSM 30 — 25 — A58 — G20

Delivery 交货期
 •LBCSK 7天发货
 •LBCSM 9天发货
 ① 上海·广州发货
 ② 数量>21时, 请另询交货期。

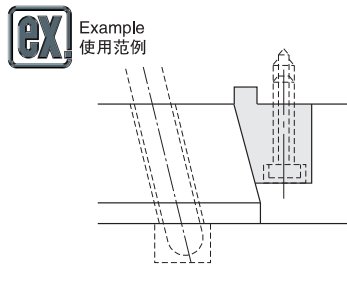

带定位楔紧块

—角度(G)指定型—

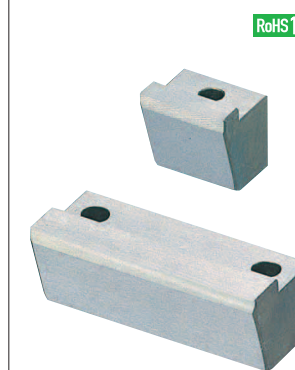

RoHS10

LBCS

A=13~23时

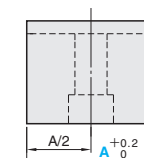

A=108~148时

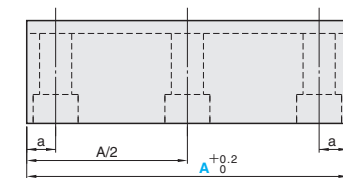

A=28~98时

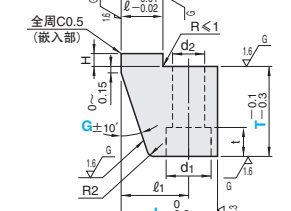
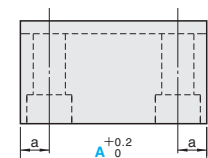

● 嵌入部の強度計算 P.1402

型号	材质	硬度
嵌入部4mm LBCS	相当于SKS3	53~56HRC

■ 嵌入部 H=4mm

H	a	l	l1	d1	d2	t	型号		A													G*					
							Type	L	T																		
4	6	6	13	9.5	5.5	6	LBCS	20	10	13	15	18	23	28	33	38	48	5~33	5~24								
									15	13	15	18	23	28	33	38	48	58	5~18	5~33							
									20	18	23	28	33	38	48	58	68	78	88	98	5~33	5~26					
									25	18	23	28	33	38	48	58	68	78	88	98	108	5~33	5~21				
									30	23	28	33	38	48	58	68	78	88	98	108	118	128	5~26	5~31			
									35	23	28	33	38	48	58	68	78	88	98	108	118	128	5~28	5~24			
	7	10	17	11	6.5	7	LBCS	25	10	15	18	23	28	33	38	48	58	68	78	88	98	108	118	128	5~28	5~24	
									15	18	23	28	33	38	48	58	68	78	88	98	108	118	128	5~28	5~24		
									20	18	23	28	33	38	48	58	68	78	88	98	108	118	128	5~28	5~24		
									25	18	23	28	33	38	48	58	68	78	88	98	108	118	128	5~28	5~24		
									30	18	23	28	33	38	48	58	68	78	88	98	108	118	128	5~28	5~24		
									35	18	23	28	33	38	48	58	68	78	88	98	108	118	128	5~28	5~24		
8	13	21	14	9	9	LBCS	30	10	15	18	23	28	33	38	48	58	68	78	88	98	108	118	128	138	5~26	5~24	
								15	18	23	28	33	38	48	58	68	78	88	98	108	118	128	138	5~26	5~24		
								20	18	23	28	33	38	48	58	68	78	88	98	108	118	128	138	5~26	5~24		
								25	18	23	28	33	38	48	58	68	78	88	98	108	118	128	138	5~26	5~24		
								30	18	23	28	33	38	48	58	68	78	88	98	108	118	128	138	5~26	5~24		
								35	18	23	28	33	38	48	58	68	78	88	98	108	118	128	138	5~26	5~24		
13	17	27	19	14	13	LBCS	40	10	15	18	23	28	33	38	48	58	68	78	88	98	108	118	128	138	5~26	5~24	
								15	18	23	28	33	38	48	58	68	78	88	98	108	118	128	138	5~26	5~24		
								20	18	23	28	33	38	48	58	68	78	88	98	108	118	128	138	5~26	5~24		
								25	18	23	28	33	38	48	58	68	78	88	98	108	118	128	138	5~26	5~24		
								30	18	23	28	33	38	48	58	68	78	88	98	108	118	128	138	5~26	5~24		
								35	18	23	28	33	38	48	58	68	78	88	98	108	118	128	138	5~26	5~24		
16	23	33	25	18	16	LBCS	50	10	15	18	23	28	33	38	48	58	68	78	88	98	108	118	128	138	148	5~26	5~24
								15	18	23	28	33	38	48	58	68	78	88	98	108	118	128	138	148	5~26	5~24	
								20	18	23	28	33	38	48	58	68	78	88	98	108	118	128	138	148	5~26	5~24	
								25	18	23	28	33	38	48	58	68	78	88	98	108	118	128	138	148	5~26	5~24	
								30	18	23	28	33	38	48	58	68	78	88	98	108	118	128	138	148	5~26	5~24	
								35	18																		